

KARE L

INS-VS1

ALL MEASUREMENTS ARE IN MILLIMETRES

MANUFACTURED FROM STAINLESS STEEL

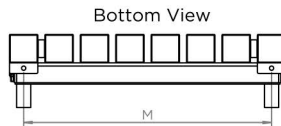
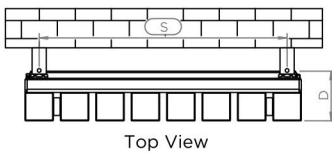
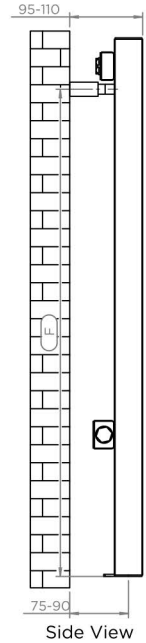
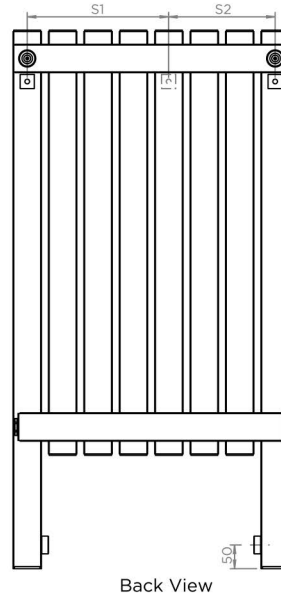
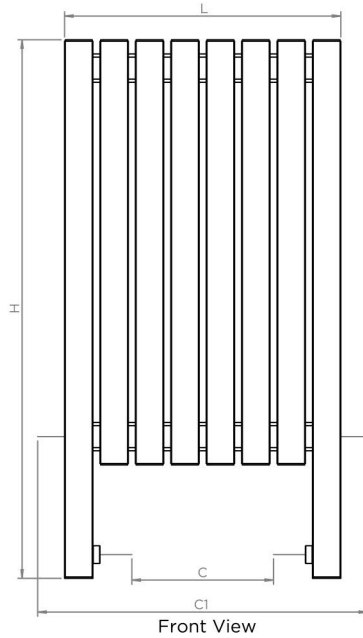
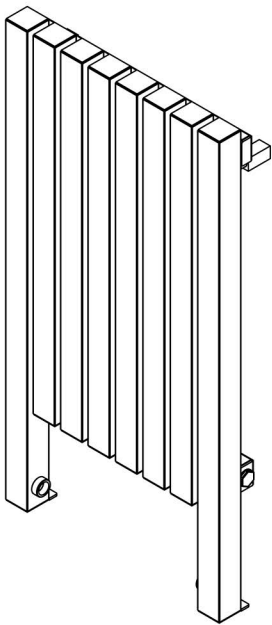

Installation Accessories:

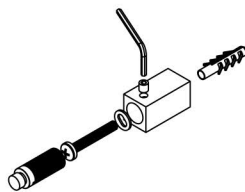
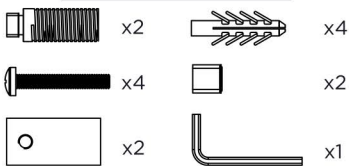

Plumbing Position:

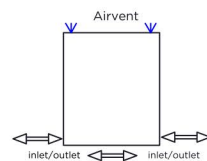

Vertical mount
 All Dimensions are in mm
 Max. Working Pressure: 10 Bar
 Max. Working Temperature: 95° C
 Inlet / Outlet : 1/2" BSP
 Fuel : E/H/D

Note: Dimension (S1,S2) available for minimum 24 profiles Manufacturing Tolerance : - 5 mm

PRODUCT CODE	Height			Length			Depth			Pipe Centres			Bracket Centres		
	H	L	D	C-C1	F	S	M	C-C1	F	S	M	C-C1	F	S	M
KRL8-7660	760	390	70	200-466	688	350	350								
KRL10-7660	760	490	70	300-566	688	450	450								
KRL12-7660	760	590	70	400-666	688	550	550								
KRL14-7660	760	690	70	500-766	688	650	650								
KRL16-7660	760	790	70	600-866	688	750	750								
KRL20-7660	760	990	70	800-1066	688	950	950								
KRL24-7660	760	1190	70	1000-1266	688	600-550	1150								
KRL28-7660	760	1390	70	1200-1466	688	700-650	1350								
KRL32-7660	760	1590	70	1400-1666	688	800-750	1550								
KRL36-7660	760	1790	70	1600-1866	688	900-850	1750								