

Built-in FLEX BAY FIREPLACES



Model: FLEX104BY.BX2

Clean Burning

Fueled by clean burning
e-NRG bioethanol

Single Room Application

Bay fireplaces feature three open
sides - view the flame from the front
and both sides.

Global Compliance

These models comply with
existing standards in the USA,
Europe, UK and Australia. UL
Listed, EN 16647 BSI Certified
and ACCC Safety Mandate
compliant.

Toughened Safety Screen

Your Flex Fireplace features
toughened glass to stabilise
the flame in windy conditions
and provide an additional layer
of safety and comfort. The
Integrated windscreen sits flush
behind the frame.

Decorative Side Box

When a decorative box is
added, the panel between the
standard fire and the decorative
box is glass.

Luxurious Finish

Available in a timeless black finish, Flex
Fireplaces come with stainless steel
burners and black glass charcoal.

Decorative Steel Log Sets

EcoSmart Fire offers non-combustible logs as an
optional, eye-catching accessory for models with the
decorative side box. Made from stainless steel with a
patina finish, they are available in different finishes.

**Decorative logs must NOT be placed directly over an
open flame. They are designed to sit near heat but not
over flames.*

Built to Last a Lifetime

Zinc sealed steel construction powder
coated with super hi-temp black paint
prevents rusting so all fireplaces can
be used both indoors or outdoors.

Zero Clearance

Self-contained, zero clearance construction allows your Flex
fireplace to be framed into wood or metal studs, providing
installation freedom and flexibility for builders, architects,
interior designers, landscapers and homeowners.

OPTIONAL ACCESSORIES



Decorative
Steel Logs



Bay Fireplaces

FLEX18
Minimum Wall Length 635mm [25in]



18BY

FLEX32
Minimum Wall Length 1,015 mm [40in]



32BY

FLEX42
Minimum Wall Length 1,270mm [50in]



42BY

FLEX50
Minimum Wall Length 1,475mm [58in]



50BY



50BY.BXL



50BY.BXR

FLEX60
Minimum Wall Length 1,730mm [68in]



60BY.BXL



60BY.BXR

FLEX68
Minimum Wall Length 1,935mm [76in]



68BY



68BY.BXL



68BY.BXR



68BY.BX2

FLEX78
Minimum Wall Length 2,190mm [86in]



78BY.BX2

FLEX86
Minimum Wall Length 2,395mm [94in]



86BY



86BY.BXL



86BY.BXR



86BY.BX2

FLEX104
Minimum Wall Length 2,855mm [112in]



104BY



104BY.BXL



104BY.BXR

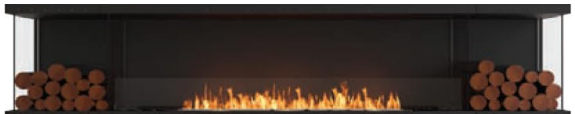

104BY.BX2

FLEX122

Minimum Wall Length 3,315mm [131in]



122BY



122BY.BX2



122BY.BXL



122BY.BXR

FLEX140

Minimum Wall Length 3,775mm [149in]



140BY.BXL



140BY.BXR



140BY.BX2

FLEX158

Minimum Wall Length 4,235mm [167in]



158BY



158BY.BX2

Bay Fireplaces

| | |
|-------------|---|
| Application | Indoor & Outdoor |
| Materials | Mild Steel (Zinc Sealed), Toughened Glass, Stainless Steel & Black Glass Charcoal as Decorative Media |
| Colours | Black Firebox, Stainless Steel Burner/s |
| Fuel Type | e-NRG Bioethanol |

FLEX18

ESF.1.FX.18BY

| | |
|--------------------------------------|--|
| Weight | 40.7kg [89.5lbs] (Incl. burner/s, glass charcoal, glass) |
| Burner* | AB3 x 1 |
| Volume Capacity | 2.5 Litres [0.7 Gallons] |
| Heats on Average (when used indoors) | Over 20 square metres [215 square feet] |
| Burn Time | 8 - 11 hours (approx) |
| Minimum Room Size | 40 cubic metres [1413 cubic feet] per fireplace. |
| Minimum Wall Length | 635mm [25in] |

FLEX32

ESF.1.FX.32BY

| | |
|--------------------------------------|---|
| Weight | 51.9kg [114.2lbs] (Incl. burner/s, glass charcoal, glass) |
| Burner* | XL500 x 1 |
| Volume Capacity | 5 Litres [1.3 Gallons] |
| Heats on Average (when used indoors) | Over 40 square metres [430.6 square feet] |
| Burn Time | 10 - 13 hours (approx) |
| Minimum Room Size | 80 cubic metres [2825 cubic feet] per fireplace. |
| Minimum Wall Length | 1,015mm [40in] |

FLEX42

ESF.1.FX.42BY

| | |
|--------------------------------------|---|
| Weight | 66.5kg [146.3lbs] (Incl. burner/s, glass charcoal, glass) |
| Burner* | XL700 x 1 |
| Volume Capacity | 7 Litres [1.8 Gallons] |
| Heats on Average (when used indoors) | Over 50 square metres [538 square feet] |
| Burn Time | 9 - 12 hours (approx) |
| Minimum Room Size | 90 cubic metres [3178 cubic feet] per fireplace. |
| Minimum Wall Length | 1,270mm [50in] |

Physical model dimensions should be verified against cut out dimensions BEFORE installation begins to confirm tolerances align.

* The efficiency data outlined above is indicative only and may vary depending on the model purchased, weather conditions, installation and bioethanol used.

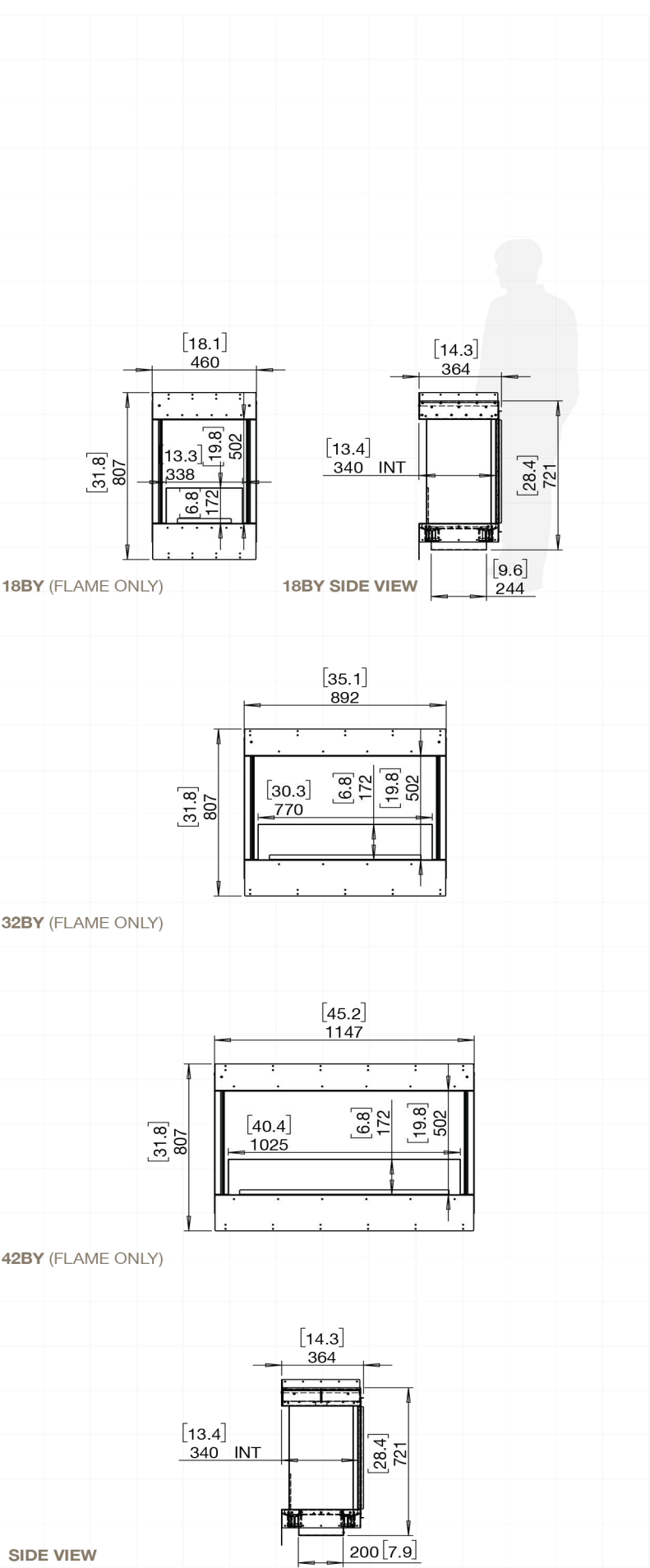

Bay Fireplaces

| | |
|-------------|---|
| Application | Indoor & Outdoor |
| Materials | Mild Steel (Zinc Sealed), Toughened Glass, Stainless Steel & Black Glass Charcoal as Decorative Media |
| Colours | Black Firebox, Stainless Steel Burner/s |
| Fuel Type | e-NRG Bioethanol |

FLEX50

| | |
|--------------------------------------|---|
| ESF.1.FX.50BY | |
| Weight | 71.8kg [158lbs] (Incl. burner/s, glass charcoal, glass) |
| Burner | XL900 x 1 |
| Volume Capacity | 9 Litres [2.4 Gallons] |
| Heats on Average (when used indoors) | Over 60 square metres [645 square feet] |
| Burn Time | 8 - 13 hours (approx) |
| Minimum Room Size | 110 cubic metres [3884 cubic feet] per fireplace. |
| Minimum Wall Length | 1,475mm [58in] |

| | |
|--------------------------------------|---|
| ESF.1.FX.50BY.BXL | |
| ESF.1.FX.50BY.BXR | |
| Weight | 76.2kg [167.6lbs] (Incl. burner/s, glass charcoal, glass) |
| Burner | XL500 x 1 |
| Volume Capacity | 5 Litres [1.3 Gallons] |
| Heats on Average (when used indoors) | Over 40 square metres [430.6 square feet] |
| Burn Time | 10 - 13 hours (approx) |
| Minimum Room Size | 80 cubic metres [2825 cubic feet] per fireplace. |
| Minimum Wall Length | 1,475mm [58in] |

Physical model dimensions should be verified against cut out dimensions BEFORE installation begins to confirm tolerances align.

These values are indicative only and may vary depending on the model purchased, installation, and the seasonal resource used to manufacture e-NRG.

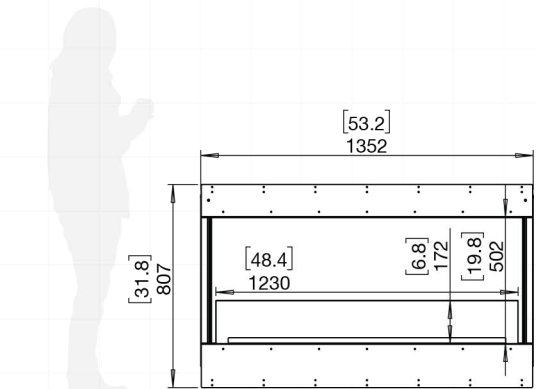

50BY (FLAME ONLY)

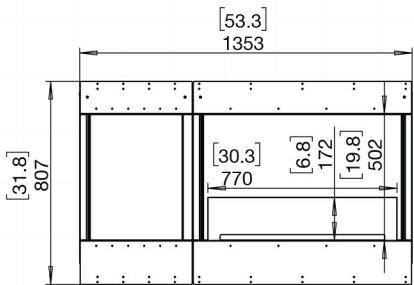

50BY.BXL (LEFT DECORATIVE BOX)

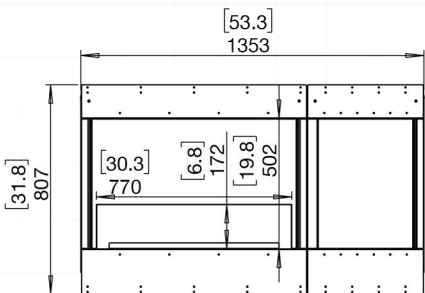

50BY.BXR (RIGHT DECORATIVE BOX)

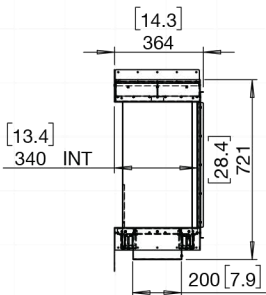

SIDE VIEW

Bay Fireplaces

| | |
|-------------|---|
| Application | Indoor & Outdoor |
| Materials | Mild Steel (Zinc Sealed), Toughened Glass, Stainless Steel & Black Glass Charcoal as Decorative Media |
| Colours | Black Firebox, Stainless Steel Burner/s |
| Fuel Type | e-NRG Bioethanol |

FLEX60

ESF.1.FX.60BY.BXL
ESF.1.FX.60BY.BXR

| | |
|---|---|
| Weight | 90.3kg [198.7lbs] (incl. burner/s, glass charcoal, glass) |
| Burner | XL700 x 1 |
| Volume Capacity | 7 Litres [1.8 Gallons] |
| Heats on Average (when used indoors) | Over 50 square metres [538 square feet] |
| Burn Time | 9 - 12 hours (approx) |
| Minimum Room Size | 90 cubic metres [3178 cubic feet] per fireplace. |
| Minimum Wall Length | 1,730mm [68in] |

Physical model dimensions should be verified against cut out dimensions BEFORE installation begins to confirm tolerances align.

These values are indicative only and may vary depending on the model purchased, installation, and the seasonal resource used to manufacture e-NRG.



60BY.BXL (LEFT DECORATIVE BOX)

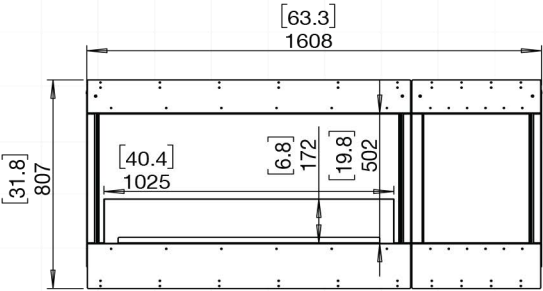

60BY.BXR (RIGHT DECORATIVE BOX)

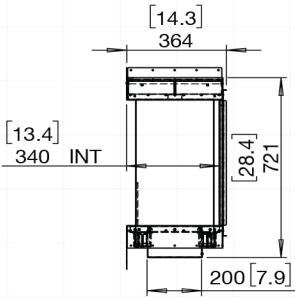

SIDE VIEW

Bay Fireplaces

| | |
|-------------|---|
| Application | Indoor & Outdoor |
| Materials | Mild Steel (Zinc Sealed), Toughened Glass, Stainless Steel & Black Glass Charcoal as Decorative Media |
| Colours | Black Firebox, Stainless Steel Burner/s |
| Fuel Type | e-NRG Bioethanol |

FLEX68

| | |
|---------------------|--|
| ESF.2.FX.68BY | |
| Weight | 103.6kg [227.9lbs] (Incl. burner/s, glass charcoal, glass) |
| Burner | XL1200 x 1 |
| Volume Capacity | 10 Litres [2.6 Gallons] x 1 |
| Heats on Average | Over 65 square metres [700 square feet] |
| Burn Time | 9 - 14 hours (approx) |
| Minimum Room Size | 115 cubic metres [4061 cubic feet] per fireplace |
| Minimum Wall Length | 1,935mm [76in] |

| | |
|---------------------|--|
| ESF.1.FX.68BY.BX2 | |
| Weight | 100.2kg [220.4lbs] (Incl. burner/s, glass charcoal, glass) |
| Burner | XL500 x 1 |
| Volume Capacity | 5 Litres [1.3 Gallons] |
| Heats on Average | Over 40 square metres [430.6 square feet] |
| Burn Time | 10 - 13 hours (approx) |
| Minimum Room Size | 80 cubic metres [2825 cubic feet] per fireplace. |
| Minimum Wall Length | 1,935mm [76in] |

| | |
|--|---|
| ESF.1.FX.68BY.BXL ESF.1.FX.68BY.BXR | |
| Weight | 95.5kg [210.1lbs] (Incl. burner/s, glass charcoal, glass) |
| Burner | XL900 x 1 |
| Volume Capacity | 9 Litres [2.4 Gallons] |
| Heats on Average | Over 60 square metres [645 square feet] |
| Burn Time | 8 - 13 hours (approx) |
| Minimum Room Size | 110 cubic metres [3884 cubic feet] per fireplace. |
| Minimum Wall Length | 1,935mm [76in] |

Physical model dimensions should be verified against cut out dimensions BEFORE installation begins to confirm tolerances align.

These values are indicative only and may vary depending on the model purchased, installation, and the seasonal resource used to manufacture e-NRG.

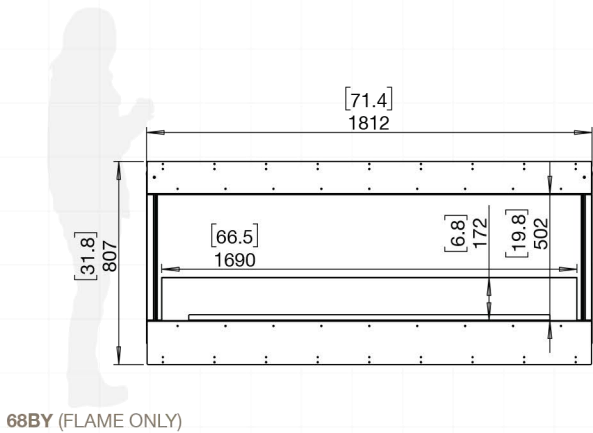

68BY (FLAME ONLY)

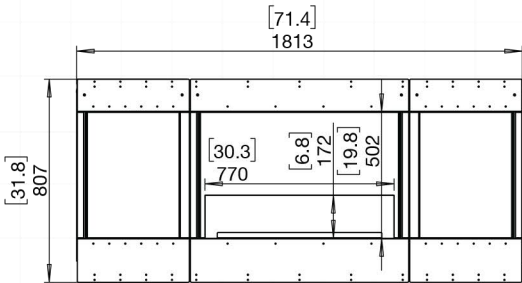

68BY.BX2 (LEFT & RIGHT DECORATIVE BOXES)

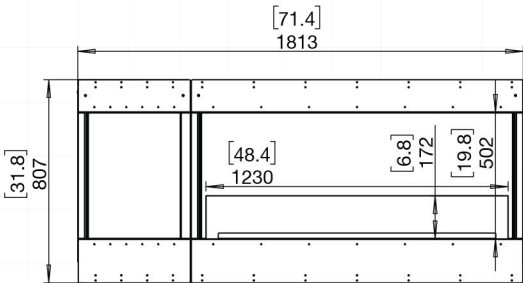

68BY.BXL (LEFT DECORATIVE BOX AS ILLUSTRATED)
68BY.BXR (RIGHT DECORATIVE BOX)

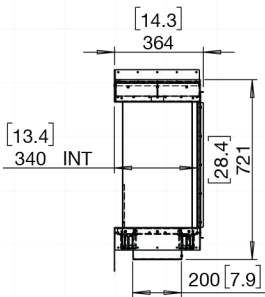

SIDE VIEW

Bay Fireplaces

| | |
|-------------|---|
| Application | Indoor & Outdoor |
| Materials | Mild Steel (Zinc Sealed), Toughened Glass, Stainless Steel & Black Glass Charcoal as Decorative Media |
| Colours | Black Firebox, Stainless Steel Burner/s |
| Fuel Type | e-NRG Bioethanol |

FLEX78

ESF.1.FX.78BY.BX2

| | |
|---|--|
| Weight | 114kg [250.8lbs] (incl. burner/s, glass charcoal, glass) |
| Burner | XL700 x 1 |
| Volume Capacity | 7 Litres [1.8 Gallons] |
| Heats on Average (when used indoors) | Over 50 square metres [538 square feet] |
| Burn Time | 9 - 12 hours (approx) |
| Minimum Room Size | 90 cubic metres [3178 cubic feet] per fireplace. |
| Minimum Wall Length | 2,190mm [86in] |

Physical model dimensions should be verified against cut out dimensions BEFORE installation begins to confirm tolerances align.

These values are indicative only and may vary depending on the model purchased, installation, and the seasonal resource used to manufacture e-NRG.

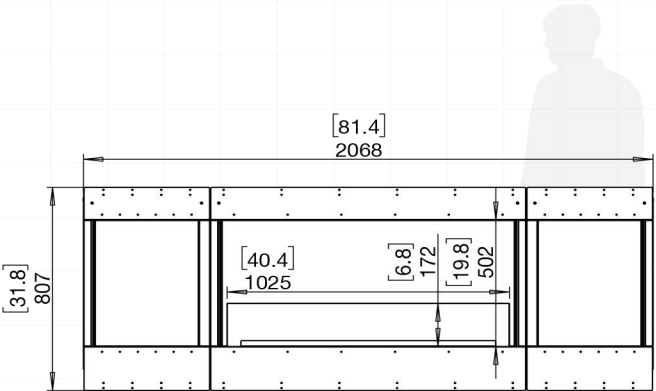

78BY.BX2 (LEFT & RIGHT DECORATIVE BOXES)

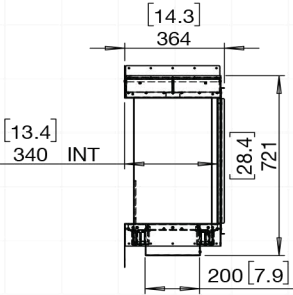

SIDE VIEW

Bay Fireplaces

| | |
|-------------|---|
| Application | Indoor & Outdoor |
| Materials | Mild Steel (Zinc Sealed), Toughened Glass, Stainless Steel & Black Glass Charcoal as Decorative Media |
| Colours | Black Firebox, Stainless Steel Burner/s |
| Fuel Type | e-NRG Bioethanol |

FLEX86

| | |
|---------------------|--|
| ESF.1.FX.86BY | |
| Weight | 121.9kg [268.2lbs] (Incl. burner/s, glass charcoal, glass) |
| Burner | XL900 x 2 |
| Volume Capacity | 9 Litres [2.4 Gallons] x 2 |
| Heats on Average | Over 120 square metres [1290 square feet] |
| Burn Time | 8 - 13 hours (approx) |
| Minimum Room Size | 220 cubic metres [7768 cubic feet] per fireplace |
| Minimum Wall Length | 2,395mm [94in] |

| | |
|---------------------|--|
| ESF.1.FX.86BY.BX2 | |
| Weight | 119.2kg [262.2lbs] (Incl. burner/s, glass charcoal, glass) |
| Burner | XL900 x 1 |
| Volume Capacity | 9 Litres [2.4 Gallons] |
| Heats on Average | Over 60 square metres [645 square feet] |
| Burn Time | 8 - 13 hours (approx) |
| Minimum Room Size | 110 cubic metres [3884 cubic feet] per fireplace |
| Minimum Wall Length | 2,395mm [94in] |

| | |
|--|--|
| ESF.2.FX.86BY.BXL ESF.2.FX.86BY.BXR | |
| Weight | 125.9kg [277lbs] (Incl. burner/s, glass charcoal, glass) |
| Burner | XL1200 x 1 |
| Volume Capacity | 10 Litres [2.6 Gallons] x 1 |
| Heats on Average | Over 65 square metres [700 square feet] |
| Burn Time | 9 - 14 hours (approx) |
| Minimum Room Size | 115 cubic metres [4061 cubic feet] per fireplace |
| Minimum Wall Length | 2,395mm [94in] |

Physical model dimensions should be verified against cut out dimensions BEFORE installation begins to confirm tolerances align.

These values are indicative only and may vary depending on the model purchased, installation, and the seasonal resource used to manufacture e-NRG.

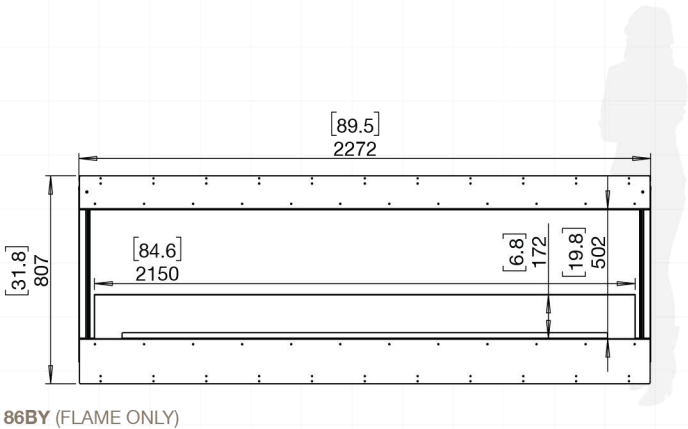

86BY (FLAME ONLY)

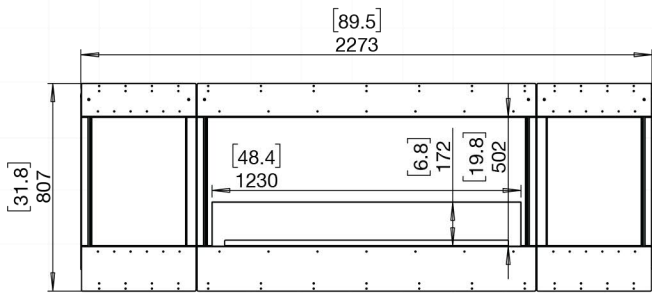

86BY.BX2 (LEFT & RIGHT DECORATIVE BOXES)

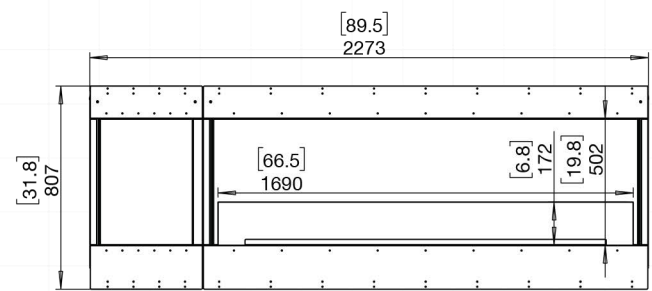

86BY.BXL (LEFT DECORATIVE BOX AS ILLUSTRATED)
86BY.BXR (RIGHT DECORATIVE BOX)

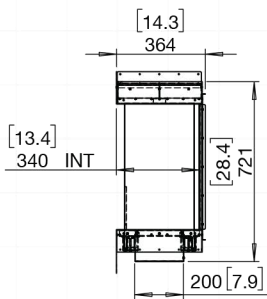

SIDE VIEW

Bay Fireplaces

| | |
|-------------|---|
| Application | Indoor & Outdoor |
| Materials | Mild Steel (Zinc Sealed), Toughened Glass, Stainless Steel & Black Glass Charcoal as Decorative Media |
| Colours | Black Firebox, Stainless Steel Burner/s |
| Fuel Type | e-NRG Bioethanol |

FLEX104

ESF.1.FX.104BY

| | |
|---------------------|--|
| Weight | 152.9kg [336.4lbs] (Incl. burner/s, glass charcoal, glass) |
| Burner | XL1200 x 2 |
| Volume Capacity | 10 Litres [2.6 Gallons] x 2 |
| Heats on Average | Over 130 square metres [1400 square feet] |
| Burn Time | 9 - 14 hours (approx) |
| Minimum Room Size | 230 cubic metres [8122 cubic feet] per fireplace |
| Minimum Wall Length | 2,855mm [112in] |

ESF.2.FX.104BY.BX2

| | |
|---------------------|--|
| Weight | 150.1kg [330.2lbs] (Incl. burner/s, glass charcoal, glass) |
| Burner | XL1200 x 1 |
| Volume Capacity | 10 Litres [2.6 Gallons] x 1 |
| Heats on Average | Over 65 square metres [700 square feet] |
| Burn Time | 9 - 14 hours (approx) |
| Minimum Room Size | 115 cubic metres [4061 cubic feet] per fireplace |
| Minimum Wall Length | 2,855mm [112in] |

ESF.1.FX.104BY.BXL
ESF.1.FX.104BY.BXR

| | |
|---------------------|--|
| Weight | 145.6kg [320.3lbs] (Incl. burner/s, glass charcoal, glass) |
| Burner | XL900 x 2 |
| Volume Capacity | 9 Litres [2.4 Gallons] x 2 |
| Heats on Average | Over 120 square metres [1290 square feet] |
| Burn Time | 8 - 13 hours (approx) |
| Minimum Room Size | 220 cubic metres [7768 cubic feet] per fireplace |
| Minimum Wall Length | 2,855mm [112in] |

Physical model dimensions should be verified against cut out dimensions BEFORE installation begins to confirm tolerances align.

These values are indicative only and may vary depending on the model purchased, installation, and the seasonal resource used to manufacture e-NRG.

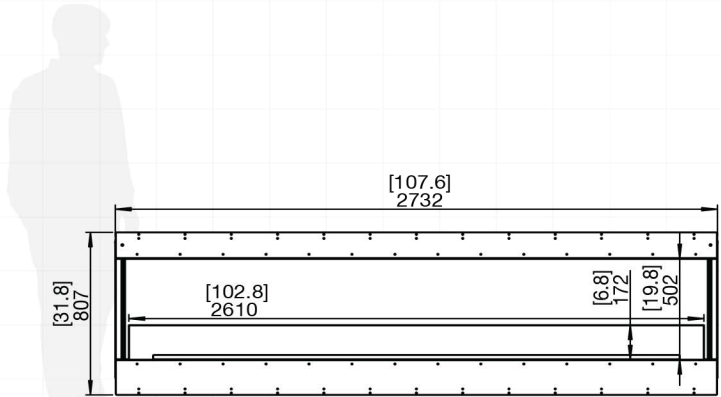

104BY (FLAME ONLY)

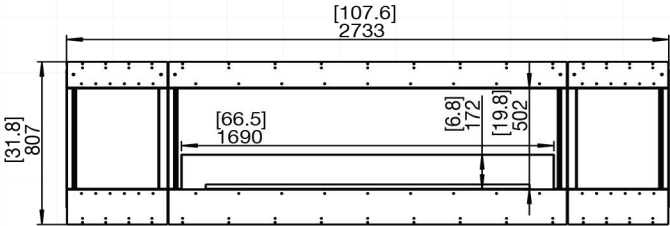

104BY.BX2 (LEFT & RIGHT DECORATIVE BOXES)

104BY.BXL (LEFT DECORATIVE BOX AS ILLUSTRATED)
104BY.BXR (RIGHT DECORATIVE BOX)

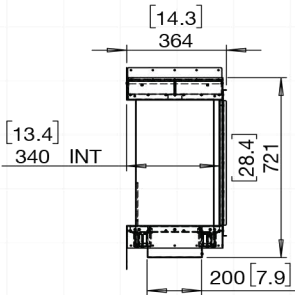

SIDE VIEW

Bay Fireplaces

| | |
|-------------|---|
| Application | Indoor & Outdoor |
| Materials | Mild Steel (Zinc Sealed), Toughened Glass, Stainless Steel & Black Glass Charcoal as Decorative Media |
| Colours | Black Firebox, Stainless Steel Burner/s |
| Fuel Type | e-NRG Bioethanol |

FLEX122

| | |
|---------------------|--|
| ESF.1.FX.122BY | |
| Weight | 171.9kg [378.2lbs] (Incl. burner/s, glass charcoal, glass) |
| Burner | XL900 x 3 |
| Volume Capacity | 9 Litres [2.4 Gallons] x 3 |
| Heats on Average | Over 180 square metres [1935 square feet] |
| Burn Time | 8 - 13 hours (approx) |
| Minimum Room Size | 330 cubic metres [11652 cubic feet] per fireplace |
| Minimum Wall Length | 3,315mm [131in] |

| | |
|---------------------|--|
| ESF.1.FX.122BY.BX2 | |
| Weight | 169.3kg [372.5lbs] (Incl. burner/s, glass charcoal, glass) |
| Burner | XL900 x 2 |
| Volume Capacity | 9 Litres [2.4 Gallons] x 2 |
| Heats on Average | Over 120 square metres [1290 square feet] |
| Burn Time | 8 - 13 hours (approx) |
| Minimum Room Size | 220 cubic metres [7768 cubic feet] per fireplace |
| Minimum Wall Length | 3,315mm [131in] |

| | |
|--|--|
| ESF.1.FX.122BY.BXL ESF.1.FX.122BY.BXR | |
| Weight | 176.7kg [388.7lbs] (Incl. burner/s, glass charcoal, glass) |
| Burner | XL1200 x 2 |
| Volume Capacity | 10 Litres [2.6 Gallons] x 2 |
| Heats on Average | Over 130 square metres [1400 square feet] |
| Burn Time | 9 - 14 hours (approx) |
| Minimum Room Size | 230 cubic metres [8122 cubic feet] per fireplace |
| Minimum Wall Length | 3,315mm [131in] |

Physical model dimensions should be verified against cut out dimensions BEFORE installation begins to confirm tolerances align.

These values are indicative only and may vary depending on the model purchased, installation, and the seasonal resource used to manufacture e-NRG.

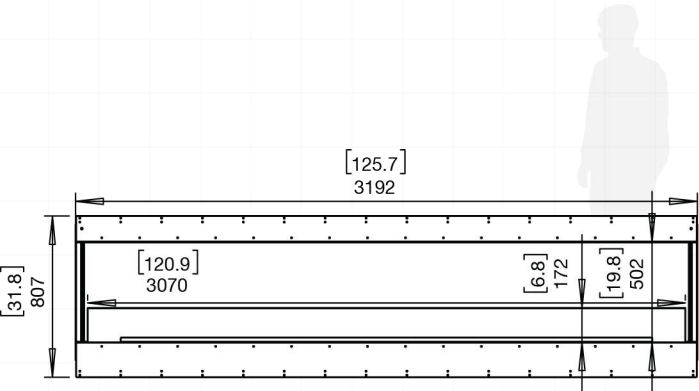

122BY (FLAME ONLY)

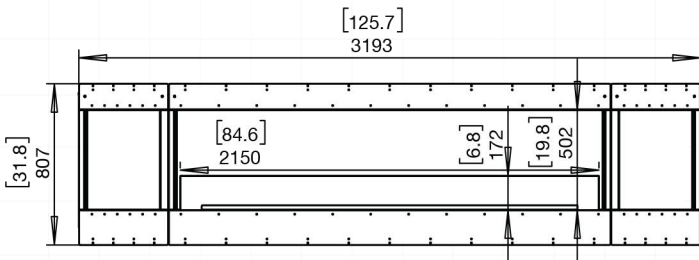

122BY.BX2 (LEFT & RIGHT DECORATIVE BOXES)

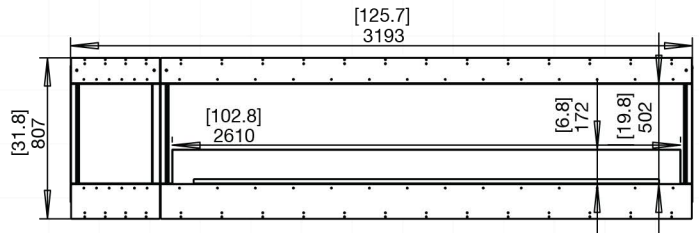

122BY.BXL (LEFT DECORATIVE BOX AS ILLUSTRATED)
122BY.BXR (RIGHT DECORATIVE BOX)

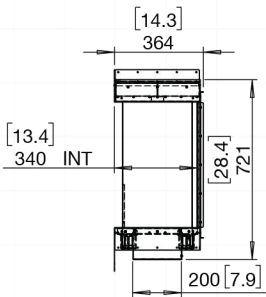

SIDE VIEW

Bay Fireplaces

| | |
|-------------|---|
| Application | Indoor & Outdoor |
| Materials | Mild Steel (Zinc Sealed), Toughened Glass, Stainless Steel & Black Glass Charcoal as Decorative Media |
| Colours | Black Firebox, Stainless Steel Burner/s |
| Fuel Type | e-NRG Bioethanol |

FLEX140

ESF.1.FX.140BY.BX2

| | |
|---------------------|--|
| Weight | 200.3kg [440.7lbs] (Incl. burner/s, glass charcoal, glass) |
| Burner | XL1200 x 2 |
| Volume Capacity | 10 Litres [2.6 Gallons] x 2 |
| Heats on Average | Over 130 square metres [1400 square feet] |
| Burn Time | 9 - 14 hours (approx) |
| Minimum Room Size | 230 cubic metres [8122 cubic feet] per fireplace |
| Minimum Wall Length | 3,775mm [149in] |

ESF.1.FX.140BY.BXL

ESF.1.FX.140BY.BXR

| | |
|---------------------|--|
| Weight | 195.6kg [430.3lbs] (Incl. burner/s, glass charcoal, glass) |
| Burner | XL900 x 3 |
| Volume Capacity | 9 Litres [2.4 Gallons] x 3 |
| Heats on Average | Over 180 square metres [1935 square feet] |
| Burn Time | 8 - 13 hours (approx) |
| Minimum Room Size | 330 cubic metres [11652 cubic feet] per fireplace |
| Minimum Wall Length | 3,775mm [149in] |

Physical model dimensions should be verified against cut out dimensions BEFORE installation begins to confirm tolerances align.

These values are indicative only and may vary depending on the model purchased, installation, and the seasonal resource used to manufacture e-NRG.

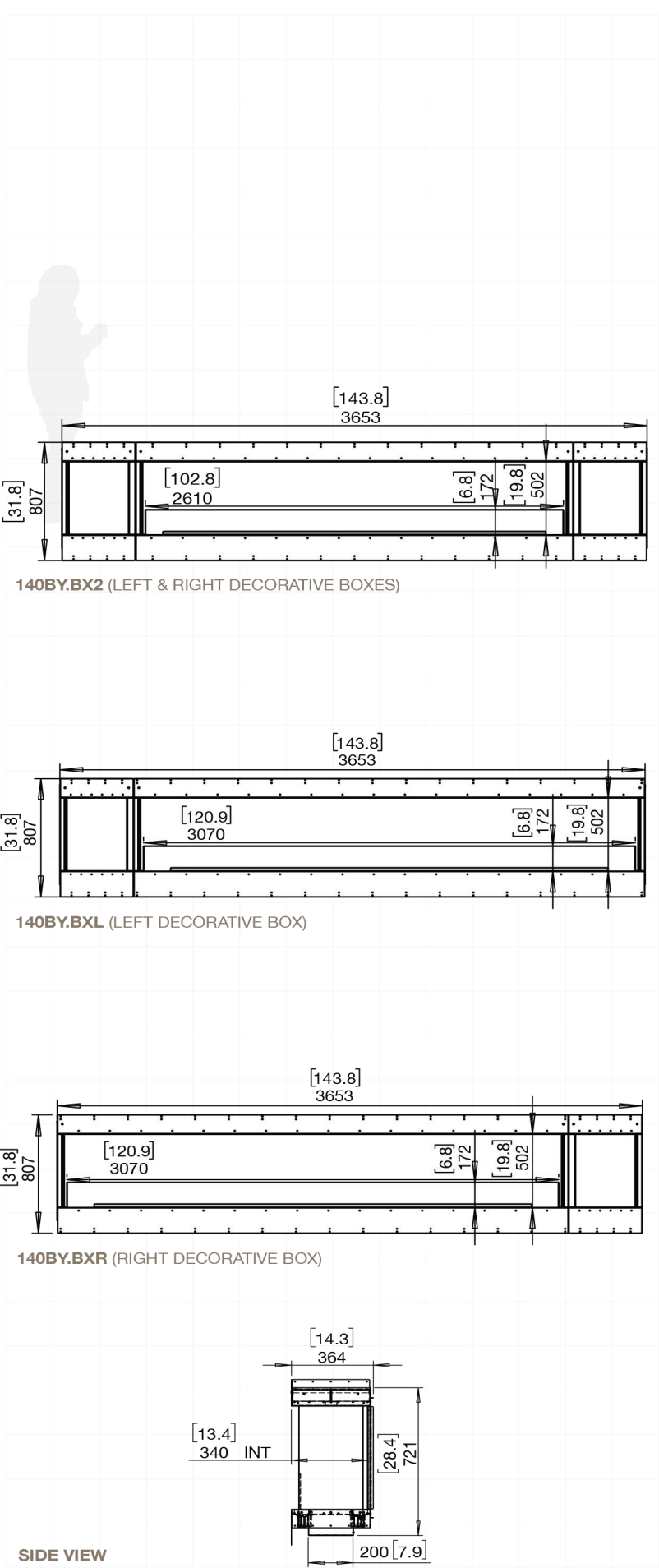

Bay Fireplaces

| | |
|-------------|---|
| Application | Indoor & Outdoor |
| Materials | Mild Steel (Zinc Sealed), Toughened Glass, Stainless Steel & Black Glass Charcoal as Decorative Media |
| Colours | Black Firebox, Stainless Steel Burner/s |
| Fuel Type | e-NRG Bioethanol |

FLEX158

| | |
|---------------------|--|
| ESF.1.FX.158BY | |
| Weight | 228.8kg [503.4lbs] (Incl. burner/s, glass charcoal, glass) |
| Burner | XL1200 x 3 |
| Volume Capacity | 10 Litres [2.6 Gallons] x 3 |
| Heats on Average | Over 195 square metres [2100 square feet] |
| Burn Time | 9 - 14 hours (approx) |
| Minimum Room Size | 345 cubic metres [12183 cubic feet] per fireplace |
| Minimum Wall Length | 4,235mm [167in] |

| | |
|---------------------|--|
| ESF.1.FX.158BY.BX2 | |
| Weight | 219.3kg [482.5lbs] (Incl. burner/s, glass charcoal, glass) |
| Burner | XL900 x 3 |
| Volume Capacity | 9 Litres [2.4 Gallons] x 3 |
| Heats on Average | Over 180 square metres [1935 square feet] |
| Burn Time | 8 - 13 hours (approx) |
| Minimum Room Size | 330 cubic metres [11652 cubic feet] per fireplace |
| Minimum Wall Length | 4,235mm [167in] |

w

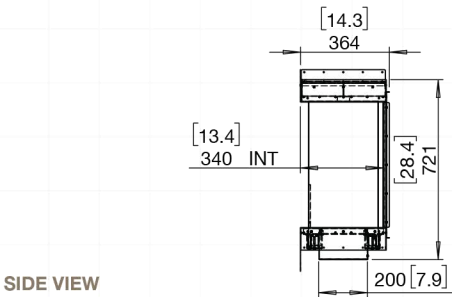
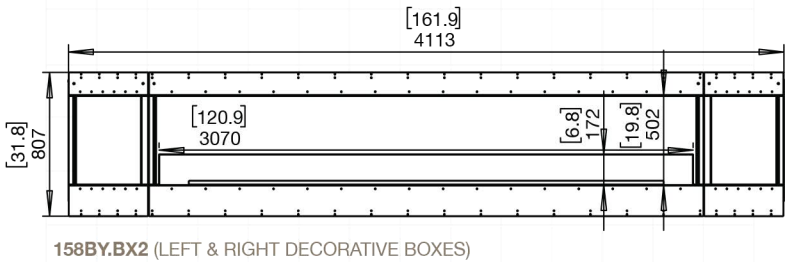
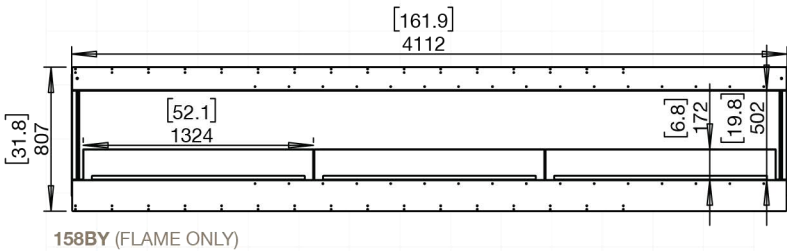

Flex Bay Fireplace indicative install

GUIDE ONLY - must read the instructions included with the model

1. Construct a main wall framework. The base of the frame can be a solid bench/platform, which will assist in leveling up the appliance when in position.



2. Slide the appliance inside the framing cavity (the base of the appliance can sit directly on top of the 2 x 4 framing material). The appliance is shipped with red stability bracket(s) installed on the open side(s) to keep the appliance square while in transport and during installation. Keep the bracket(s) on while framing up the setting to assist in minimising movement of the appliance.

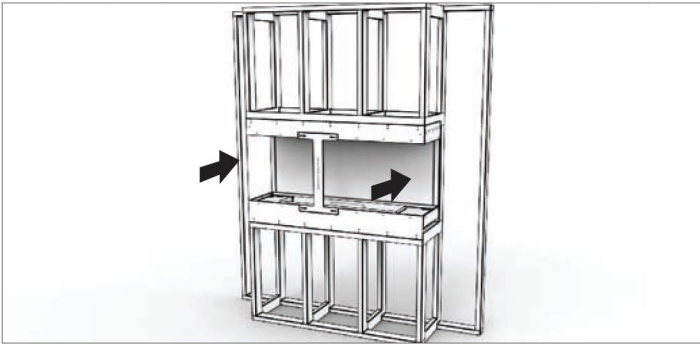

3. Ensure that the left and right side edges of the appliance are flush to the frame-work studs.

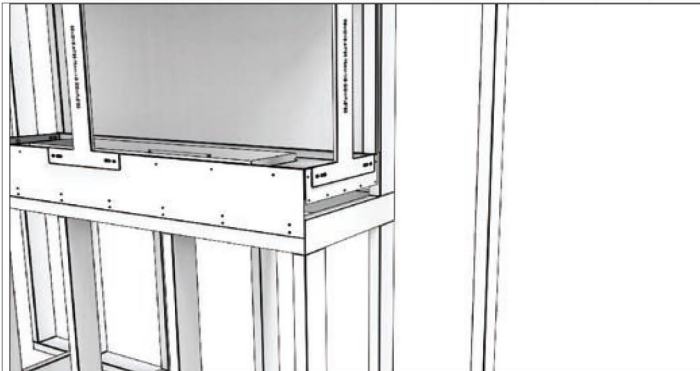

4. Secure the appliance to the framework with screws using the existing mounting holes on the appliance flanges. Make sure that the appliance is level before securing it in place.

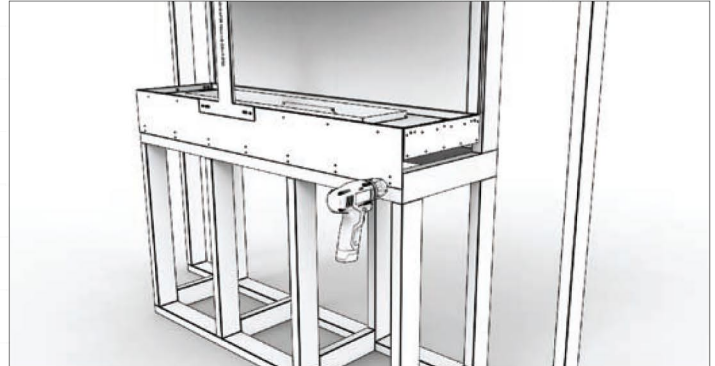

5. Remove the red stability brackets.

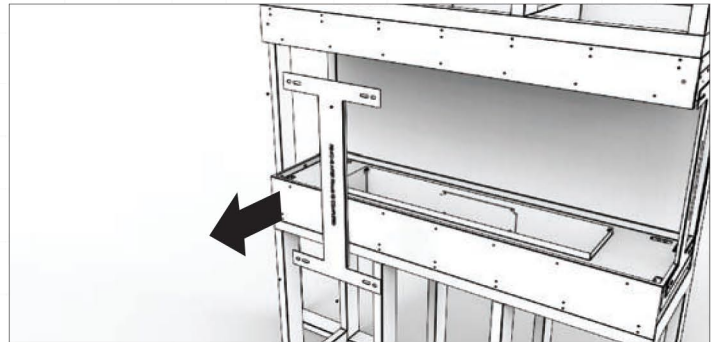

6. Complete the construction by finishing the wall paneling around the appliance. (See section on **FINISHING INSTRUCTIONS** and ensure that you fully understand where non combustible materials must be used.)

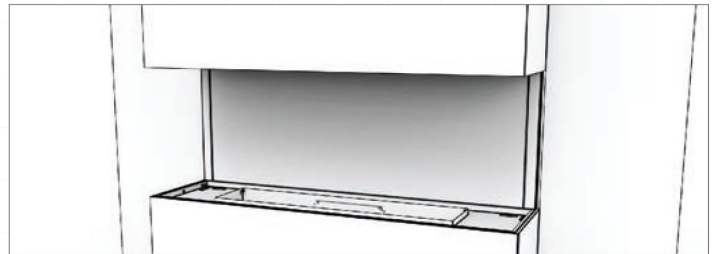

7. Place the burner into position.

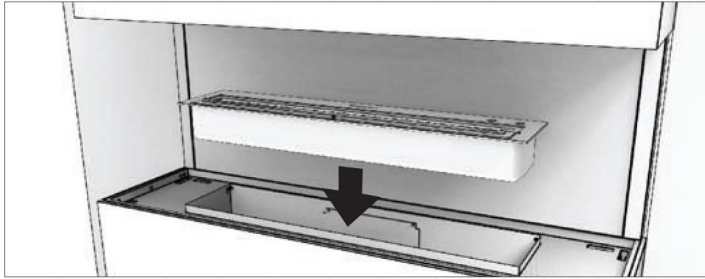

8. Remove the dust protective tape that covers the windscreen mounting slots.

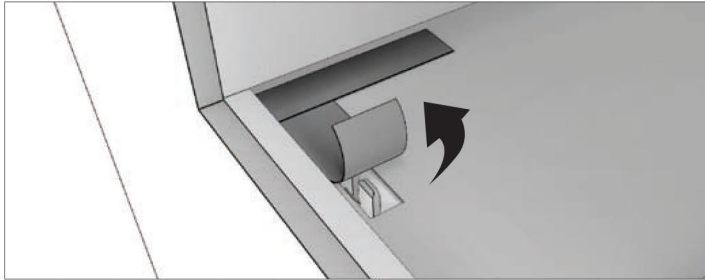

9. If your appliance includes a decorative box on the left / right or both, insert the internal glass panel by feeding the glass upwards into the slot then pushing down into the positioned clips.

**Decorative logs must NOT be placed directly over an open flame. They are designed to sit near heat but not over flames.*

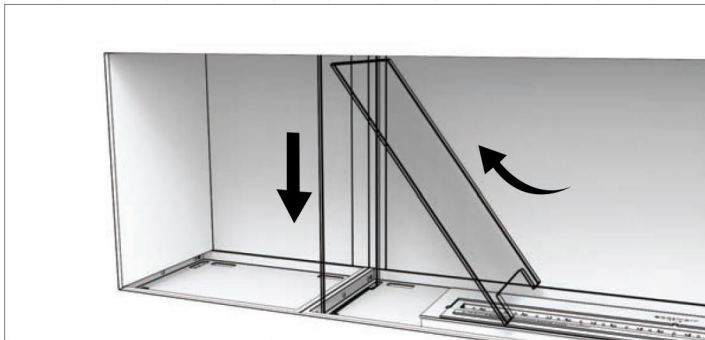

10. Insert the full height glass panel into one of the open end side by inserting the glass into the opening at the top of the appliance, and lowering it into the slots in the base until it bottoms out into place. Repeat the same for the other side of the appliance.

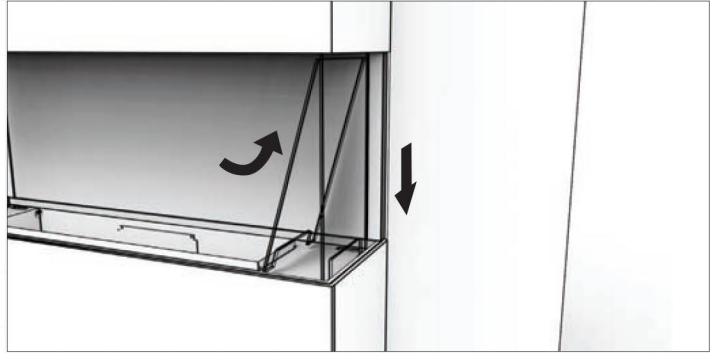

11. Install the windscreen by inserting the two ends into appropriate slots in the appliance. Use a small amount of pressure to push the windscreen in place until it bottoms out into the hidden glass clips.

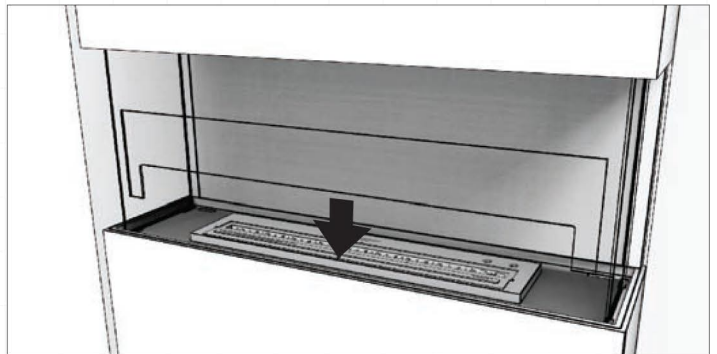

12. Spread the black glass charcoal evenly around the appliance tray.

