

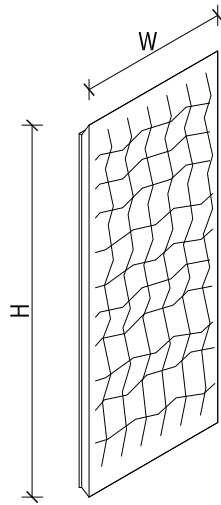

Yin Trama



STANDARD BRACKET SIZE 45mm

OPTIMAL BRACKET SIZE 30mm

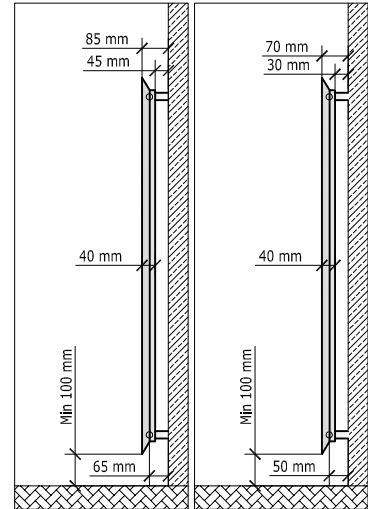

H altezza height hauteur altura	W larghezza width largeur anchura	T interasse Tap to tap distance entraxe inter-espacio	litri liters litres litros	resa output rendement rendimento	
				ΔT 30° C	ΔT 50° C
[mm]	[mm]	[mm]	[Lt]	[W]	[W]
400	1.760	360	3,7	184	867
960	960	920	3,5	469	1.189
1.600	640	1.560	3,4	796	1.317
2.000	320	1.960	1,7	1.000	726

AVAILABLE CONNECTIONS

- I =entrata / in
- O =uscita / out
- ▲ D =diaframma / Diaphragm
- I =interasse / interspace
- AV =Sfiato / air vent

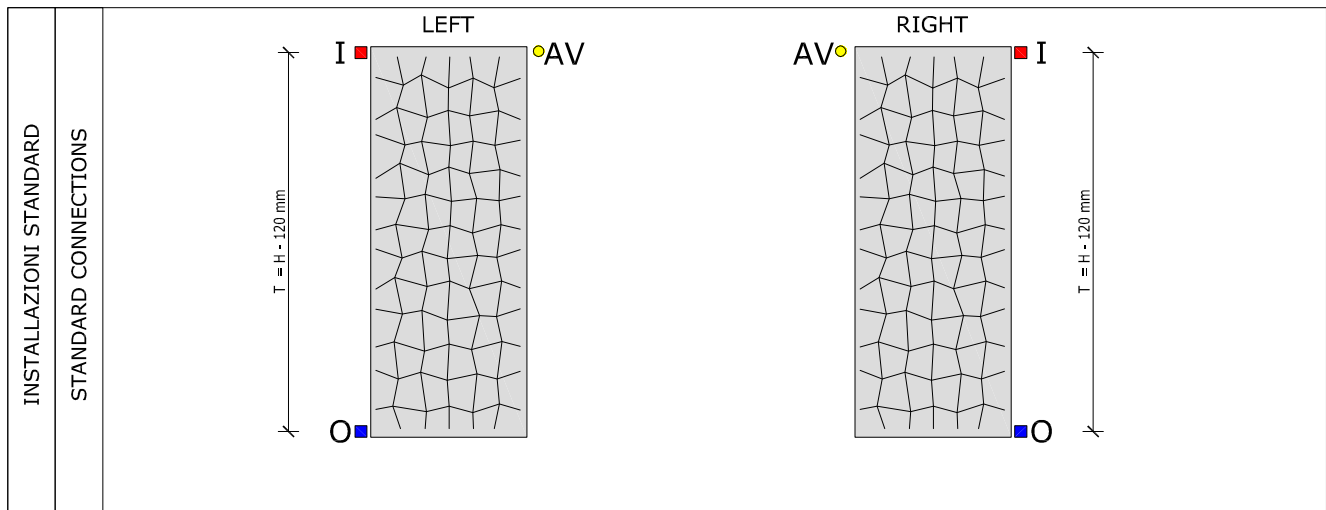

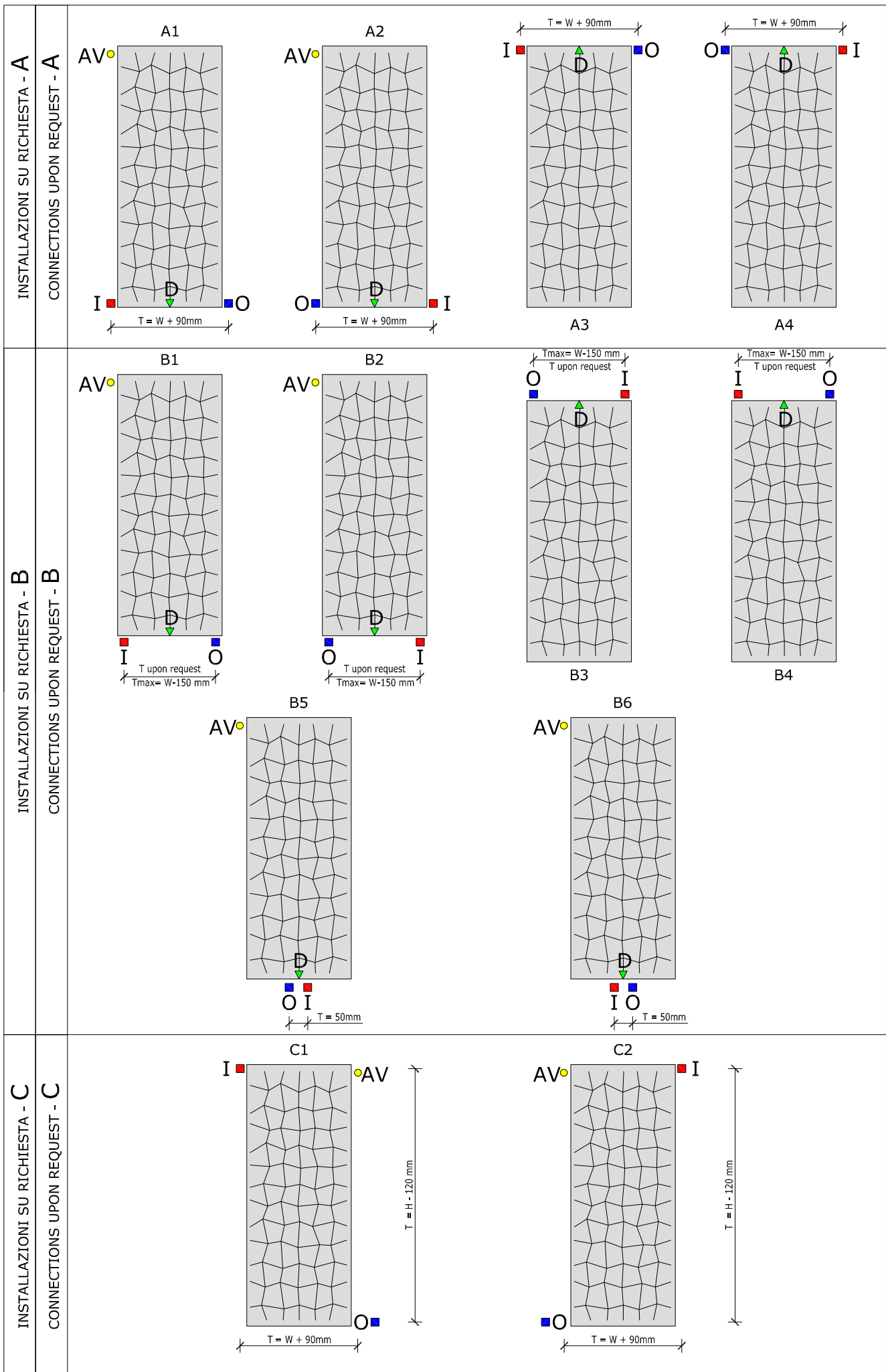

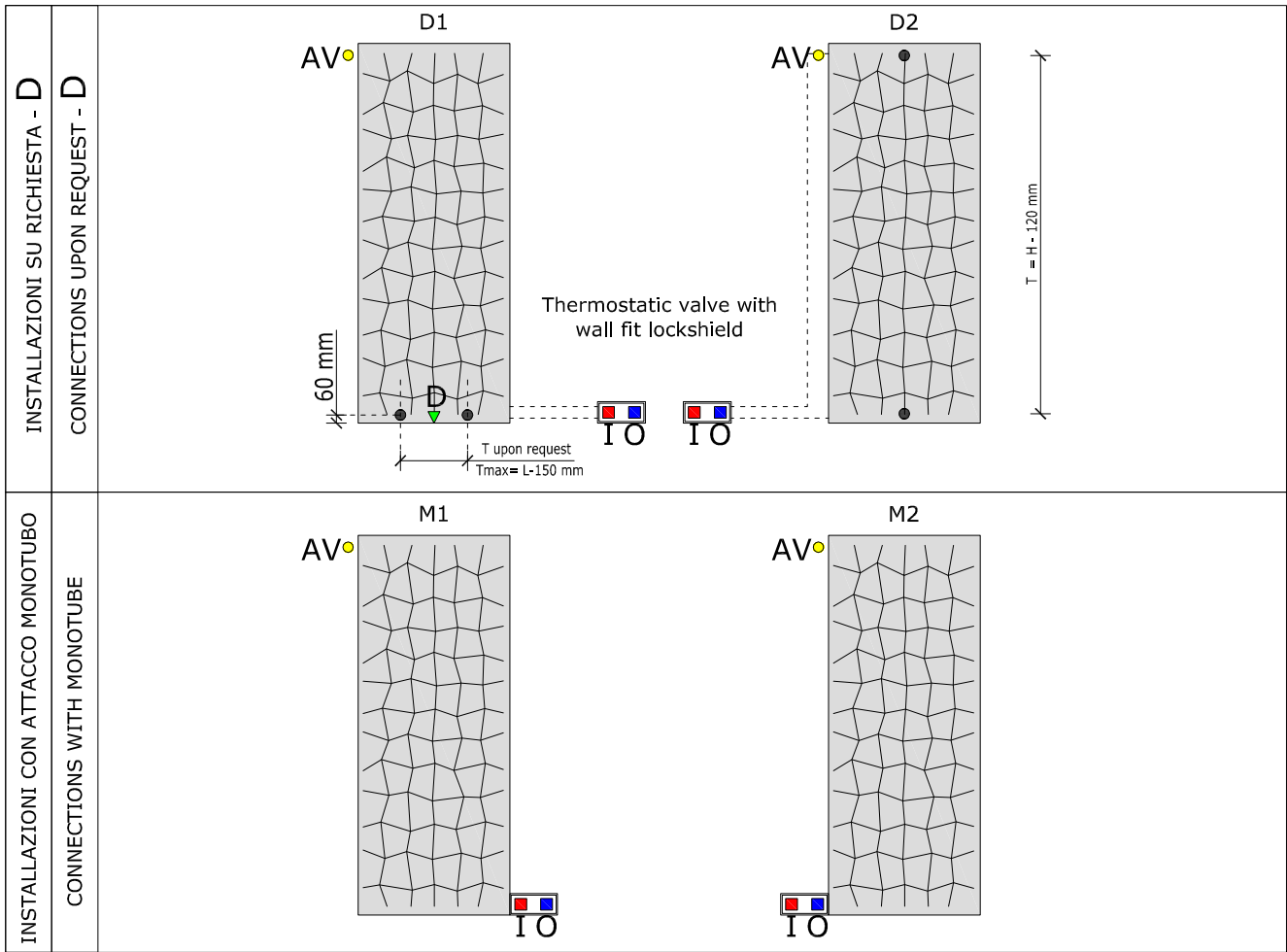

ELECTRIC CONFIGURATIONS

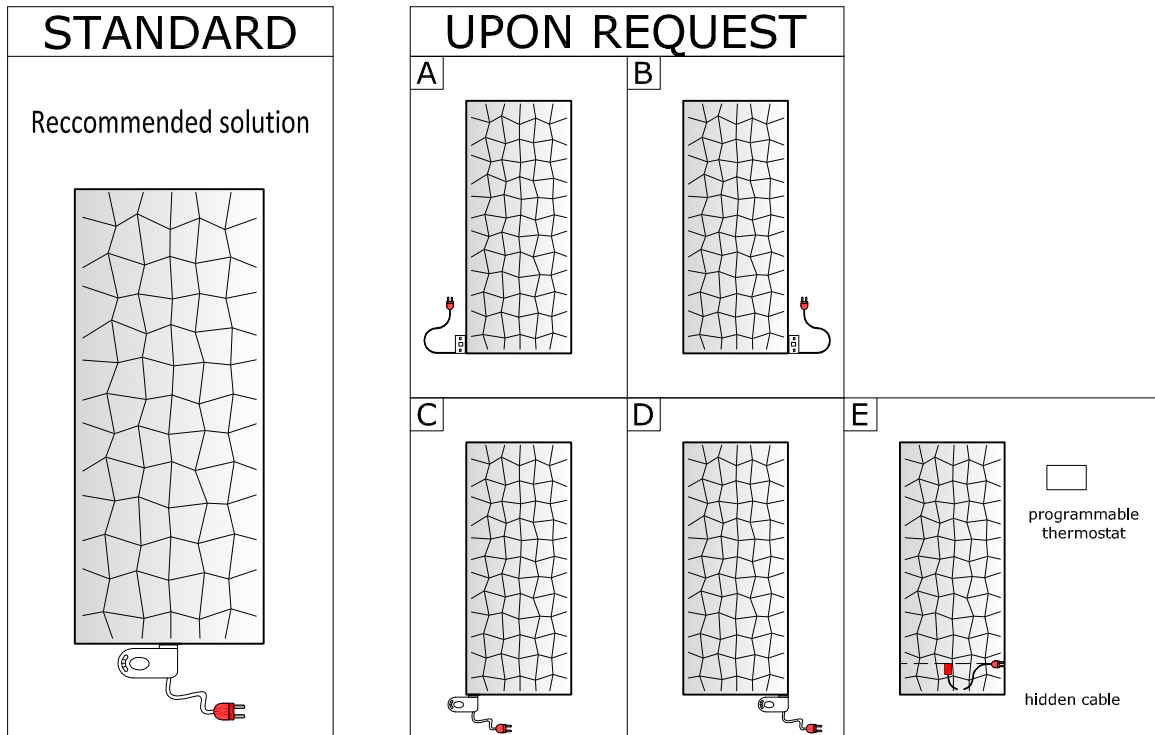

Electric radiators need a programmable thermostat
according to "EcoDesign" european directive

ELECTRIC CONFIGURATIONS

- Cable length about 1.2 mt
- Analogic or digital thermostat available as an option
- Freezing protection up to $T = -15^{\circ}$, available protection up to $T = -38^{\circ}$ upon request

WARNING: some configurations may not be available depending on the size

NOTE FOR INSTALLER : The installation must ensure that the power cord is not directly in contact with the radiator

PROHIBITED CONFIGURATIONS

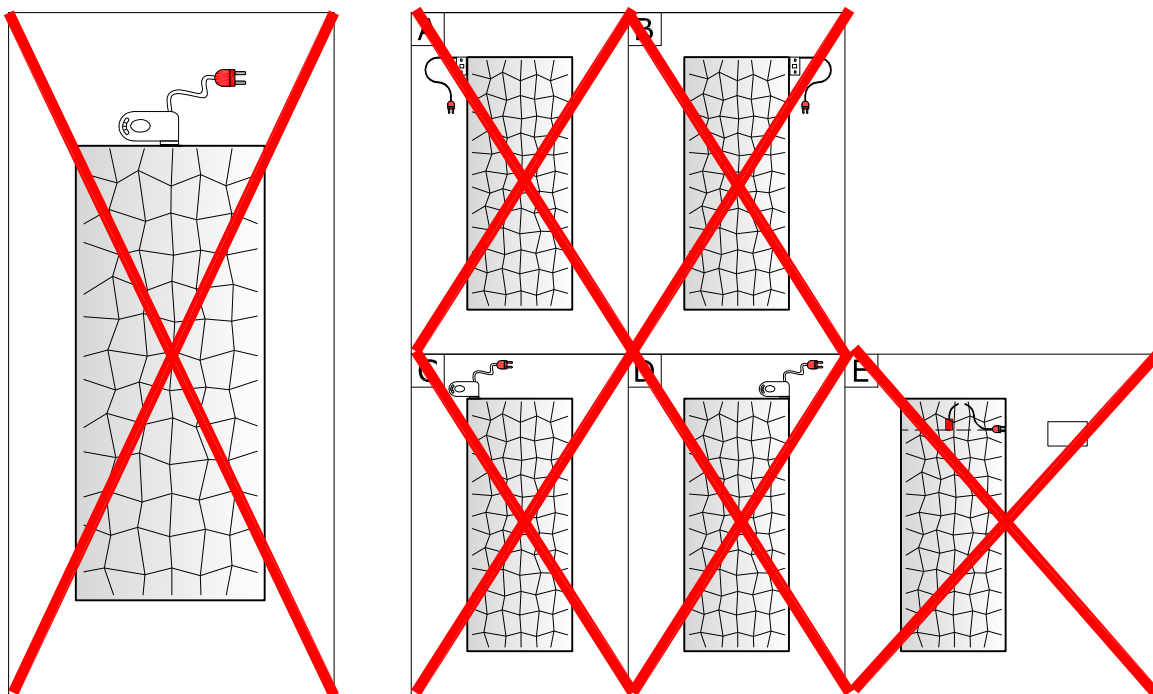

WARNING:

- The configurations barred are PROHIBITED and therefore K8 will not accept any liability for their use

DUAL FUEL POSSIBLE CONFIGURATIONS

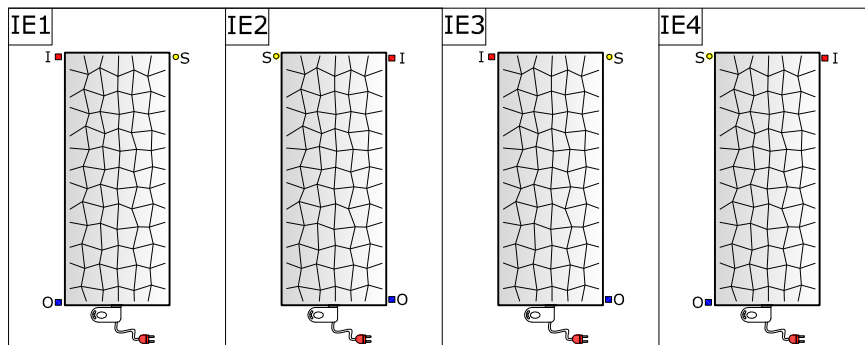

Dual Fuel version are only available with standard or "C" water connections

BRACKETS MOUNTING INSTRUCTIONS

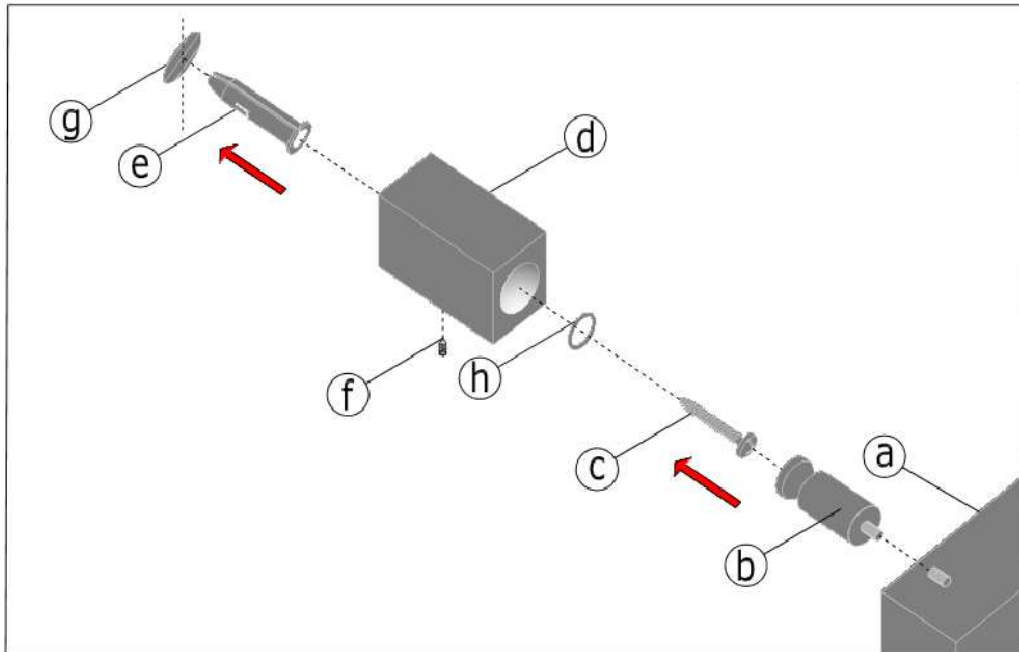

COMPONENTS

- a) Radiator
- b) Linchpin
- c) Screw
- d) Bracket
- e) Nog
- f) Head-less screw
- g) Hole in the wall
- h) washer

INSTRUCTIONS

- 1) Screw the linchpin (b) onto the black of the radiator (a)
- 2) Putt the Nog (e) in the wall hole (g)
- 3) Fasten the bracket (d) to the wall with the screw (c) and the washer (h)
- 4) Mount the radiator so the linchpins go into the brackets
- 5) Thighten the head-less screw (f)

WALL BRACKET POSITION

